

GENERAL ARRANGEMENTS  
SUB-STRUCTURE & DRAINAGE SETTING OUT [1:50]

ADD 206mm TO OVERALL FOR PERIMETER FACE BRICK TO DPC LEVEL

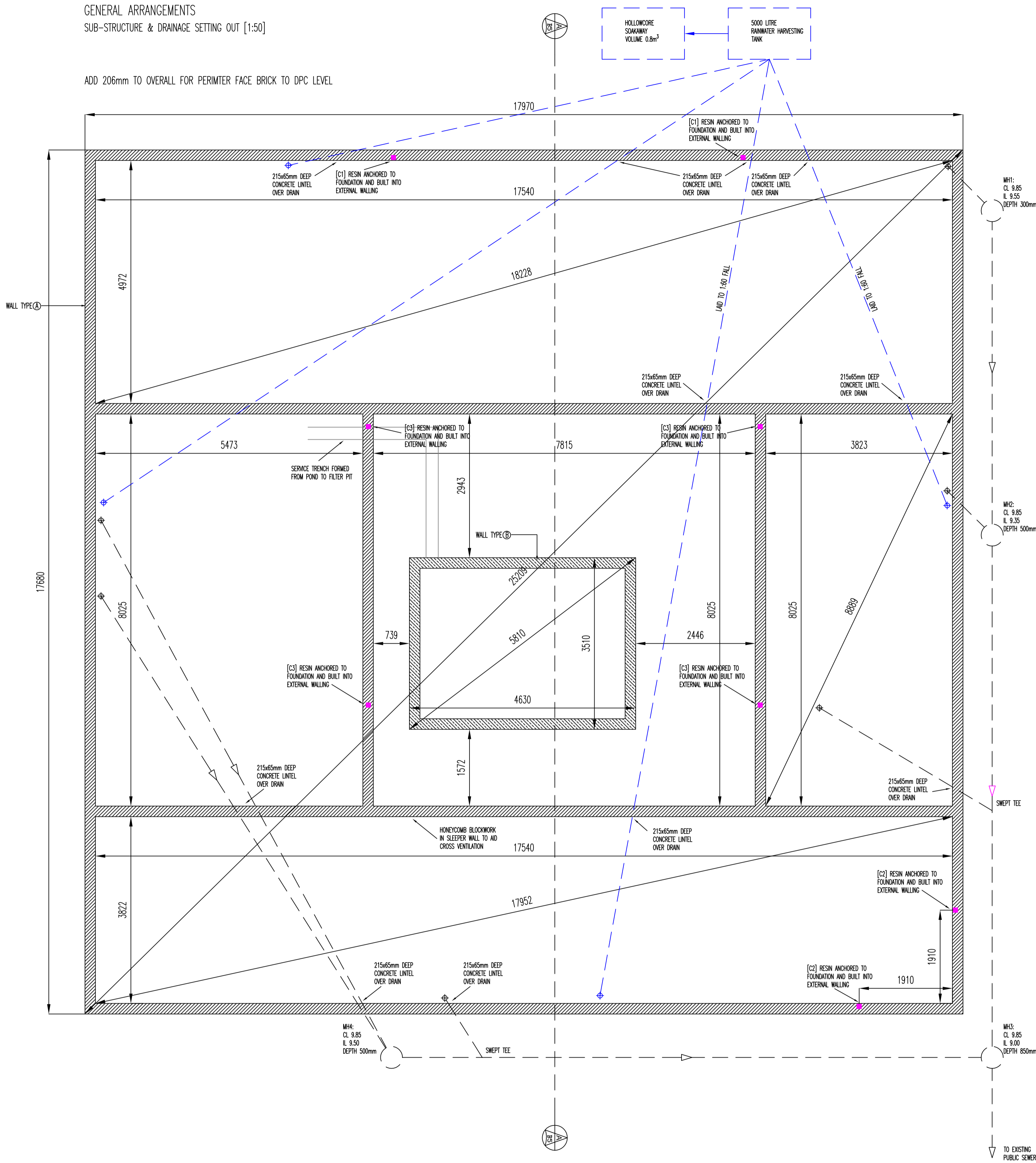

BEAM SCHEDULE

BEAM NUMBER	SECTION SIZE	DETAIL
B1	PFC 150x90x24kg	MITRE AND CAP PLATE CONNECTION (SEE DETAIL A)
B2	PFC 150x90x24kg	MITRE AND CAP PLATE CONNECTION (SEE DETAIL A)
B3	PFC 380x100x54kg	6x200mm STEEL BASE PLATE WELDED TO BOTTOM FLANGE
B4	PFC 230x90x32kg	CUT LENGTH ONLY
B5	UB 152x89x16kg	CUT LENGTH ONLY
B6	PFC 380x100x54kg	DRILLED FOR FIN PLATE CONNECTION (SEE DETAIL B)
B7	PFC 300x100x46kg	DRILLED FOR FIN PLATE CONNECTION (SEE DETAIL B)
C1	SHS 90x90x5mm	CAP & BASE PLATE (SEE DETAIL C)
C2	SHS 90x90x5mm	CAP & BASE PLATE (SEE DETAIL C)
C3	SHS 90x90x5mm	CAP & BASE PLATE (SEE DETAIL C)

PADSTONE & PIER SCHEDULE

ID	SIZE (LxDxH)	CONSTRUCTION DETAILS
P1	325x150x100mm	CLASS B ENGINEERING BRICK

-WALLS SHOWN AS SUPPORTING BEAM & PADSTONES ASSUMED LOAD-BEARING-CONTRACTOR TO VERIFY THE CONTRACTOR IS TO CONFIRM THIS PRIOR TO STARTING STRUCTURAL WORK  
-WHERE NO PADSTONE IS ANNOTATED, UNREINFORCED OR EXISTING MASONRY IS SUITABLE  
-UNLESS NOTED MINIMUM BEARING LENGTH TO BE 100mm  
-REFER TO CALCULATIONS FOR CONNECTION DETAILS  
\*\*\* NO STEEL TO BE ORDERED UNTIL CALCULATIONS ARE APPROVED BY BUILDING CONTROL \*\*\*

TIMBER MEMBER SCHEDULE

MEMBER	TIMBER SIZE/GRADE	DETAILS
UPPER WALLPLATE	47x97mm C16	M10 RESIN ANCHORED TO WALL @ 600mm C/C
LOWER WALLPLATE	47x97mm C16	STRAPPED TO TO INNER LEAF @1500mm C/C
FLOOR JOIST	63x225mm OPEN WEB ENGINEERED FLOOR JOIST	
STUD WALL	38x89mm CLS	400mm C/C

WALL KEY

- WALL TYPE (A) (Sub-structure wall)  
215mm o/a (structural)  
215mm 3.6N block laid flat
- WALL TYPE (B) (Koi pond retaining wall)  
250mm o/a (structural)  
100mm 7N Block  
50mm concrete cavity  
100mm 7N Block
- WALL TYPE (C) (9" Masonry)  
225mm o/a (structural)  
100mm 3.6N Inner leaf block  
100mm 3.6N Inner leaf block  
100mm XPS External insulation  
3mm Monocouche render
- WALL TYPE (D) (internal wall- habitable space)  
101mm o/a (finished)  
1x 70mm Gyproc Metal studs @400mm centres  
70mm Metal Sole and Head plates  
75mm Mineral wool insulation (min density 25kg/m³)  
12.5mm plasterboard with skim finish (both sides)
- WALL TYPE (E) (internal wall-non habitable space)  
101mm o/a (finished)  
1x 70mm Gyproc Metal studs @400mm centres  
70mm Metal Sole and Head plates  
12.5mm plasterboard with skim finish (both sides)
- WALL TYPE (F) (Load bearing wall)  
100mm o/a (structural)  
100mm 3.6N block  
13mm browning coat & plaster skim

[B3] INSTALLATION DETAIL (BIFOLD DOOR GOALPOST)

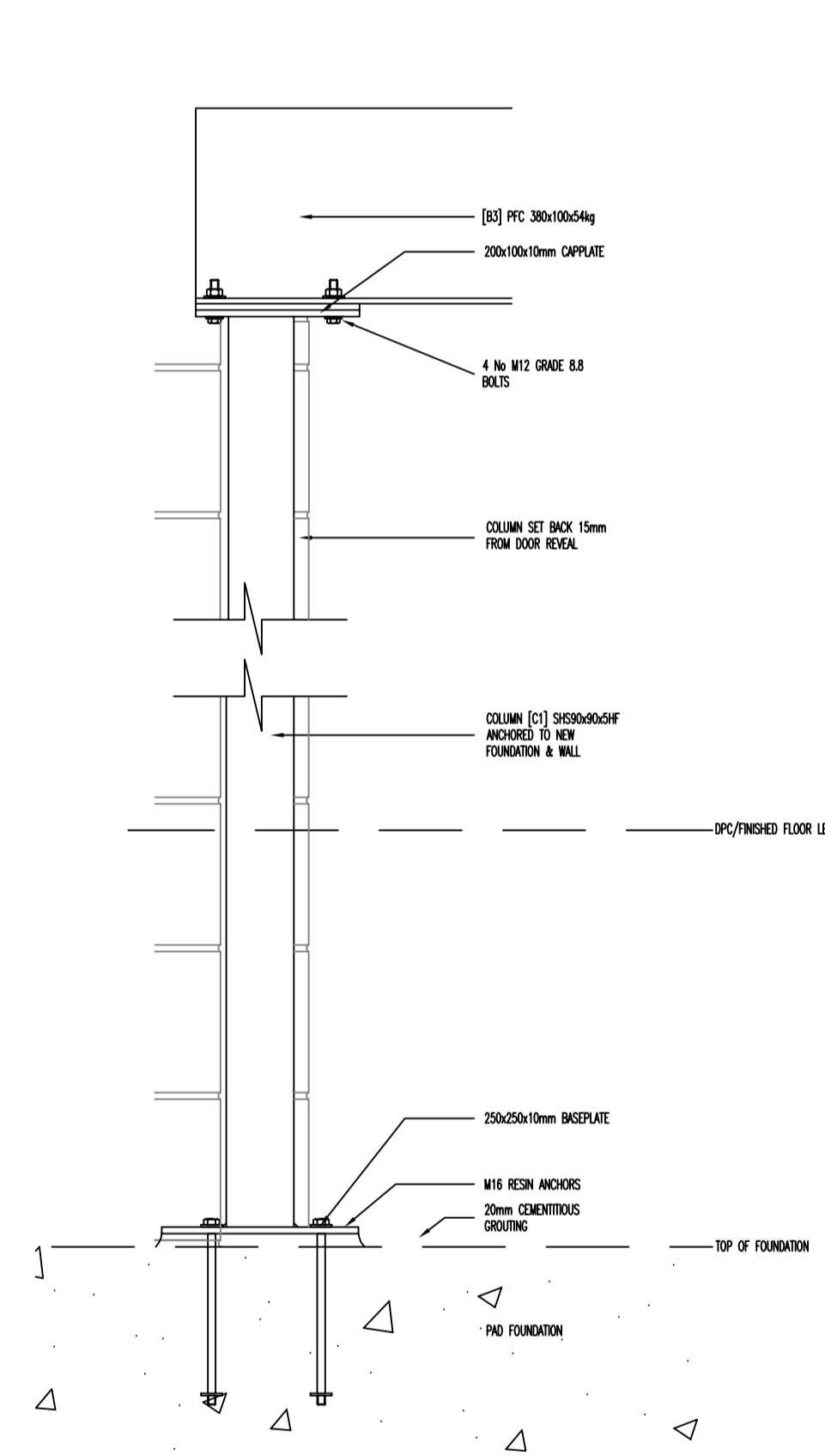

[B3] INSTALLATION DETAIL (BIFOLD DOOR GOALPOST)

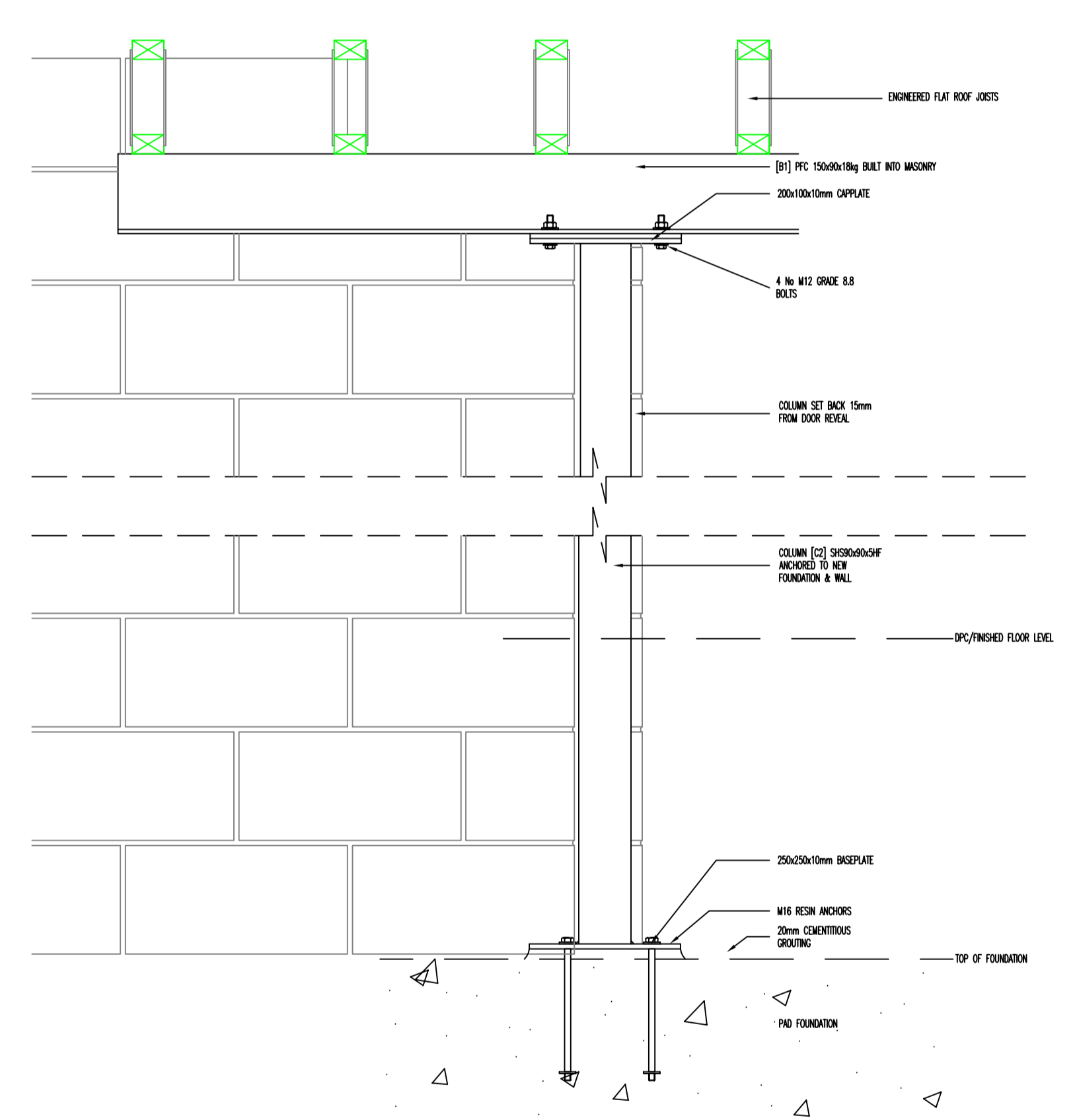

CDM REGULATIONS 2015:  
THIS PROPOSAL FALLS WITHIN THE REQUIREMENTS OF CONSTRUCTION, DESIGN & MANAGEMENT REGULATIONS 2015. THE CLIENT IS RESPONSIBLE FOR THE APPOINTMENT OF A CDM PRINCIPAL DESIGNER & PRINCIPAL CONTRACTOR. THE PRINCIPAL CONTRACTOR WILL BE REQUIRED TO PERFORM CONSTRUCTION TASKS IN ACCORDANCE WITH THE HEALTH & SAFETY PLAN AND ADOPT THEM DURING THE CONSTRUCTION PHASE & TO IMPLEMENT THE REQUIREMENTS SET OUT BY THE PRINCIPAL CDM DESIGNER

<p><b>Consulting Engineers</b> Design • Plan • Manage</p> <p>TEL: (01525) 717124   admin@apengineers.co.uk</p>	CLIENT	MR & MRS SIMPKINS			
	PROJECT TITLE	NEW DWELLING			
	SITE ADDRESS	REAR OF 29 MAIN STREET, LITTLE THETFORD, ELY. CB6 3HA			
	DRAWING NAME	SUB-STRUCTURE SETTING OUT			
DRAWING NUMBER	16.385-B3	SCALE: 1:100   1:50   1:25   1:200   1:500   1:1250			
REVISION	PURPOSE	DATE	- ANNOTATED DIMENSIONS & PITCHES MUST BE ASSUMED APPROXIMATE - DO NOT SCALE FOR CONSTRUCTION PURPOSES - DIMENSIONS, PITCHES & LEVELS TO BE CHECKED ON SITE - REFER TO SECONDARY DOCUMENTS LISTED ON THIS DRAWING - WORK SHOULD NOT PROCEED UNTIL DRAWINGS ARE APPROVED BY LA IF IN DOUBT CONSULT THE DESIGNER PRIOR TO COMMENCING WORK	SURVEY DATE	16.02.2017
[1] NEW	BUILDING REGULATIONS	16.02.2017		SURVEY BY	PS
				DRAWN BY	PA
© CONTENTS OF DRAWING COPYRIGHT OF AP CONSULTING ENGINEERS LTD					